

# HAMMER LOCK

# P1

Center Punch Clamp  
Tensioning Tool

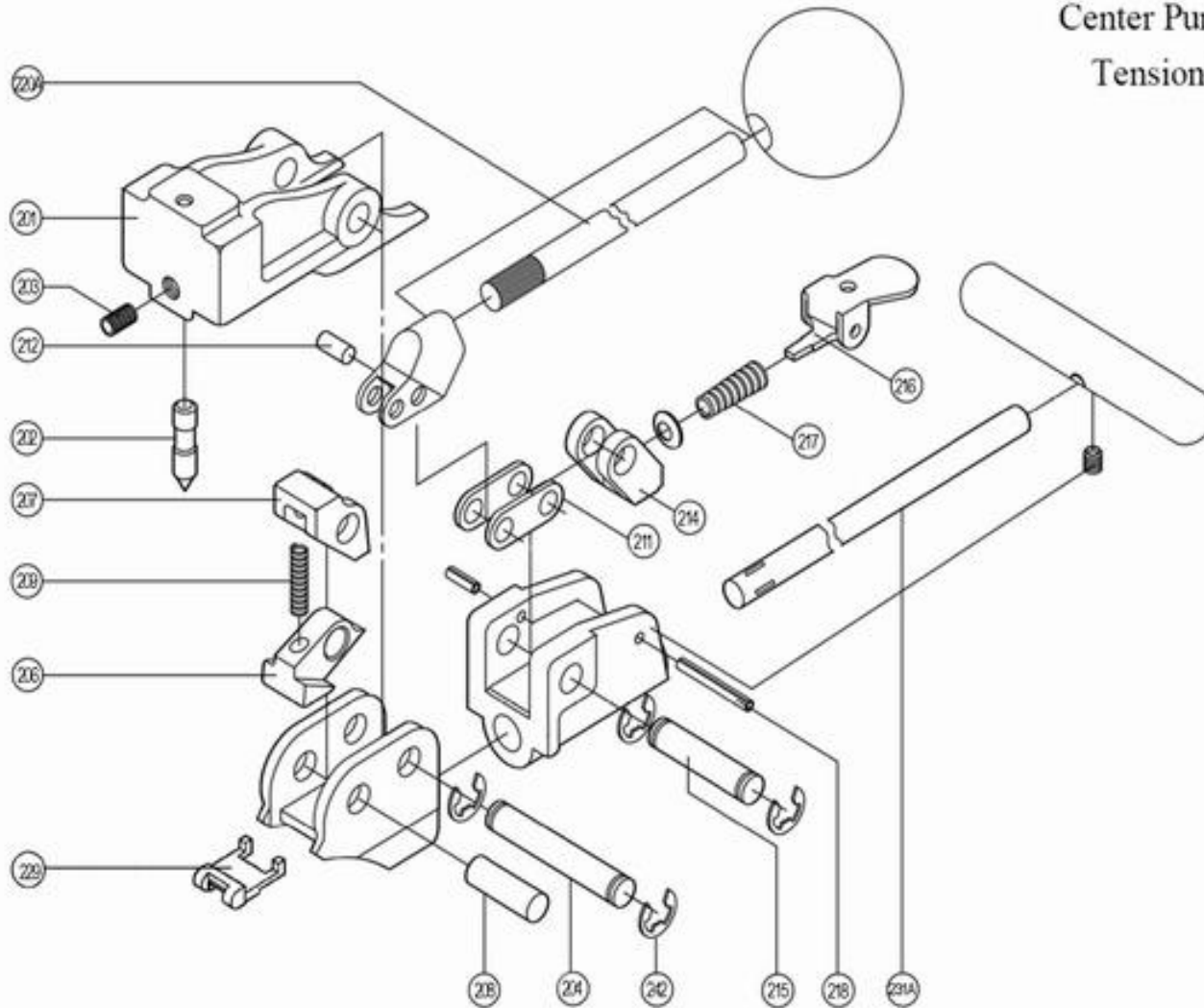

## PARTS LIST

| Part No | Description            | QTY |
|---------|------------------------|-----|
| P1-201  | PUNCH HEAD             | 1   |
| P1-202  | PUNCH                  | 1   |
| P1-203  | SET SCREW              | 1   |
| P1-204  | PUNCH HEAD PIN         | 1   |
| P1-206  | PUSHER NOSE            | 1   |
| P1-207  | HOLDING DOG            | 1   |
| P1-208  | PUSHER NOSE PIN        | 1   |
| P1-209  | HOLDING DOG SPRING     | 1   |
| P1-211  | PULLER LINK            | 2   |
| P1-212  | PULLER LINK PIN        | 1   |
| P1-214  | PULLING DOG            | 1   |
| P1-215  | PULLING DOG PIN        | 1   |
| P1-216  | RELEASE LEVER          | 1   |
| P1-217  | PULLING DOG SPRING     | 1   |
| P1-218  | RELEASE LEVER PIN      | 1   |
| P1-220A | BALL HANDLE ASSEMBLY   | 1   |
| P1-229  | 3/8" CLAMP ADAPTER     | 1   |
| P1-231A | PUSHER PULLER ASSEMBLY | 1   |
| P1-242  | RETAINING RINGS        | 1   |

Please order parts by number and name

## **How to use the P1 Hammer Lock Center Punch Clamp Tensioning Tool**

1. *Slide clamps over hose*
2. *Insert fittings into hose*
3. *Push ball of Hammer Lock tool upwards and insert tail end of clamp under the pusher nose and push all the way into the buckle.*
4. *Tighten the clamps by using downward strokes on the ball handle. Shorten the length of strokes as the clamp tension increases.*
5. *“Generally” tighten the clamp until the outside surface of the clamp is flush with the outside of the hose. Leave the ball handle in the down position after the last stroke. (not applicable for layflat hoses or hose with exceptionally thick wall)*
6. *With the assembly resting on a solid surface, the Hammer Lock tool held parallel to the surface and with a firm grasp on the ball and ‘T’ handle; strike the punch head a hard blow(s) with a hammer to lock the clamp.*

*Note – ensure sufficient tension is applied to the clamp as to avoid fitting blow out.*  
*Caution – over tensioning of the clamp can result in reinforcement damage resulting in premature failure of hose.*
7. *Grasp the hose assembly in one hand and the Hammer Lock ball handle and ‘T’ handle together in the other hand. Lift and lower the Hammer Lock tool until the clamp tail end breaks.*
8. *To remove the tail piece of the clamp from the Hammer Lock tool, lift and lower the ball handle to ratchet the clamp piece past the holding dog the press the release lever and pull it through the rear.*